

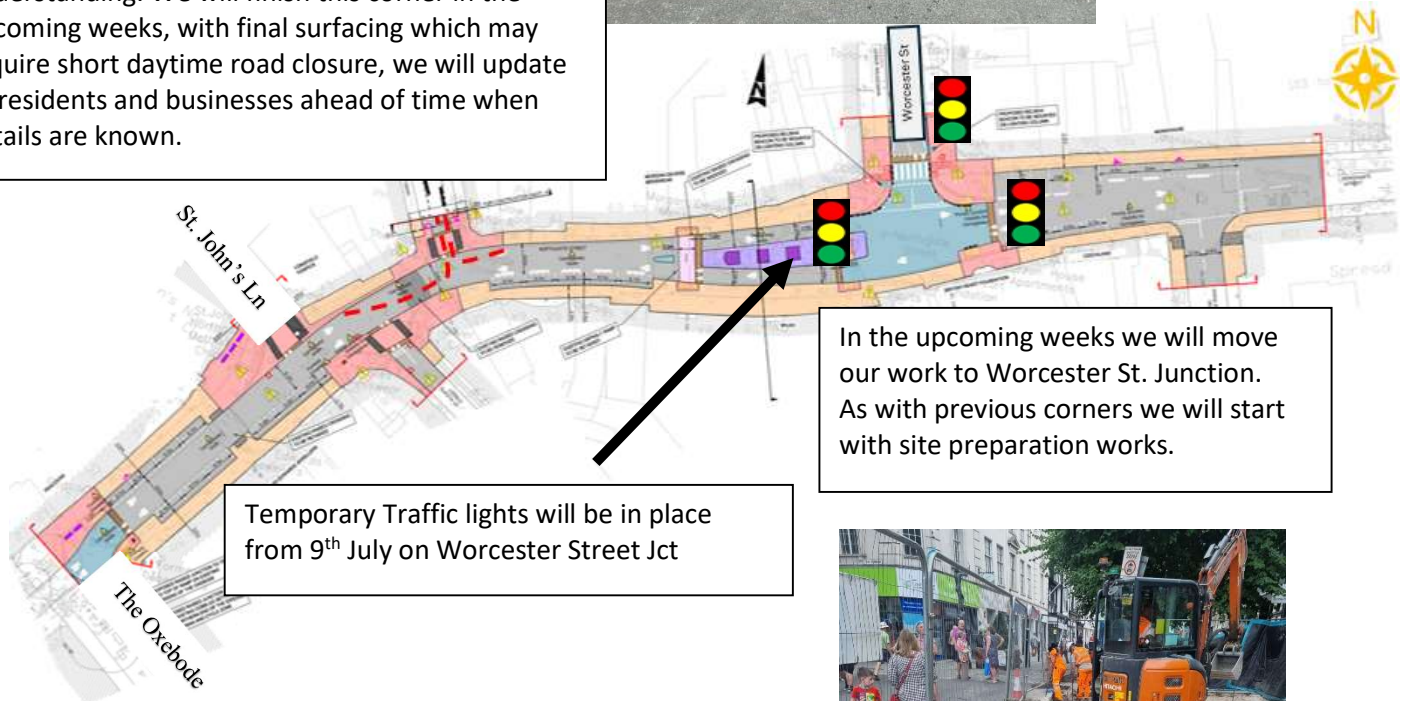

Gloucester City Centre Improvement Scheme (Northgate & Southgate)

We are pleased to inform you that the work on St John's Lane has progressed well, and the road has now been reopened following a one-week closure. As shown in the photo to the right, barriers and fencing remain in place to maintain safe pedestrian access while work continues on the footpath. However, vehicular access has now resumed, and cars are permitted to travel in and out as normal. We would like to extend our sincere thanks to all local businesses and residents affected by the recent closure for their cooperation and understanding. We will finish this corner in the upcoming weeks, with final surfacing which may require short daytime road closure, we will update all residents and businesses ahead of time when details are known.



In the upcoming weeks we will move our work to Worcester St. Junction. As with previous corners we will start with site preparation works.

Temporary Traffic lights will be in place from 9th July on Worcester Street Jct

We have now moved works over to The Oxbode corner as well and we are progressing well. As with previous part of works, we have started with site clearance. This includes removing current surface, getting access to drainage and removing the excavated materials away from the area.



If you have any specific queries, concerns or would like to be added to the mailing list:
Please contact: customerservice@montel-group.com





Southgate



Work is progressing well in Southgate Street.
We continue with removal of slabs and installation of new surface.
Barriers and cones are in place for everyone's safety.

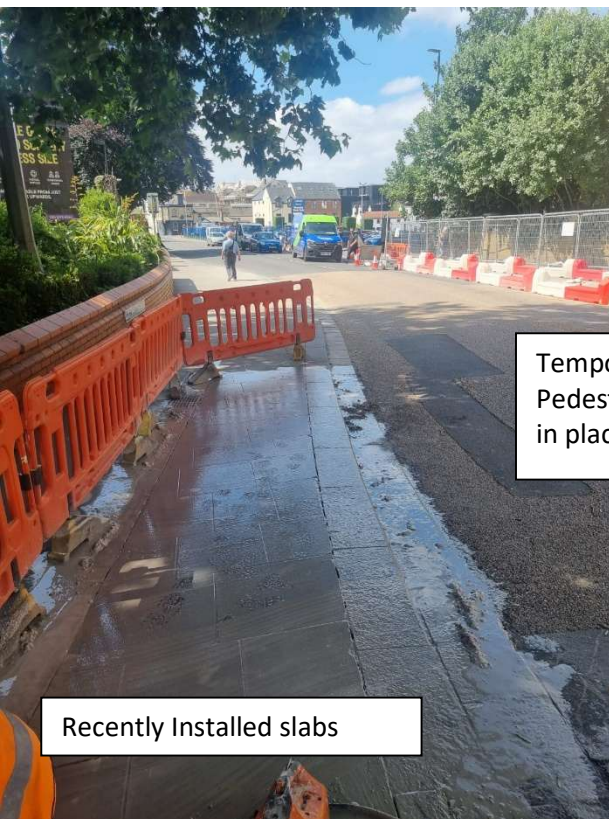

Recently Installed slabs

This area (Blue arrow) is now nearing completion. We are currently making final adjustments and carrying out quality checks to ensure the highest standards are maintained. We will move more work towards green arrow - which will include site preparation and drainage.

Temporary Traffic lights remain in place. Pedestrian barriers and diversions are also in place for everyone's safety.

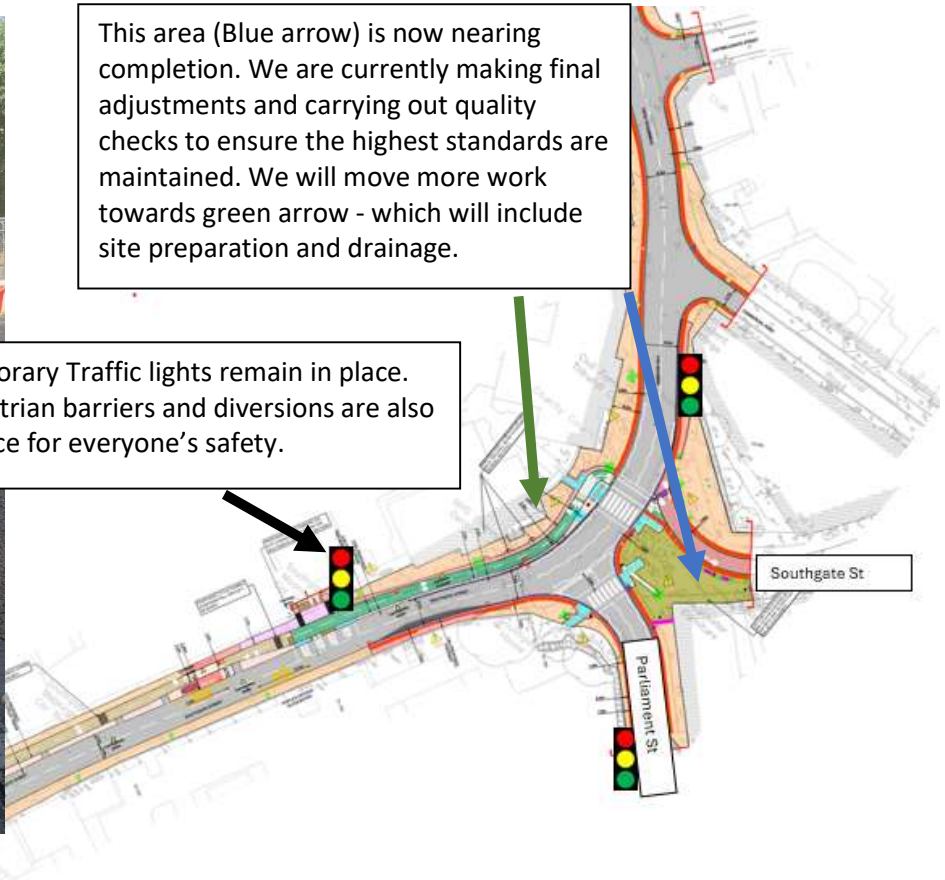

If you have any specific queries, concerns or would like to be added to the mailing list:
Please contact: customerservice@montel-group.com

