

PROPOSED UNDER GLOUCESTERSHIRE COUNTY COUNCIL ON STREET PARKING ORDER 2017 (NORTHGATE STREET AND HARE LANE) (WESTGATE WARD) (GLOUCESTER CITY) (VARIATION) ORDER 2025

File name: C:\USERS\NMB01\WSP\0365\UK040751.1114 - GLOPSF25 - BLACK DOG WAY DETAILED REVIEW - 03 WIP\03 HIGHWAYS\03 DRAWINGS\40751.1114-WSP-TTM-BDW-DR-CH-001202 & 001203 - CONSOLIDATED.DWG, printed on 05 February 2026 09:59:20, by Babala, Mohit

THIS MAP IS BASED ON ORDNANCE SURVEY MATERIAL WITH THE PERMISSION OF ORDNANCE SURVEY ON BEHALF OF CONTROLLER OF HIS MAJESTY'S STATIONERY OFFICE. YOU ARE NOT PERMITTED TO COPY, SUB-LICENSE, DISTRIBUTE OR SELL ANY OF THIS DATA TO THIRD PARTIES IN ANY FORM. © CROWN COPYRIGHT AND DATABASE RIGHTS 2020. ORDNANCE SURVEY 100019134.

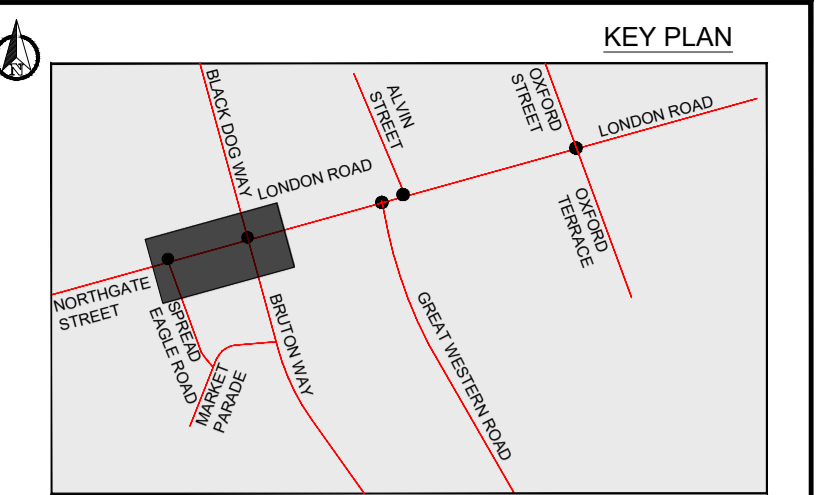
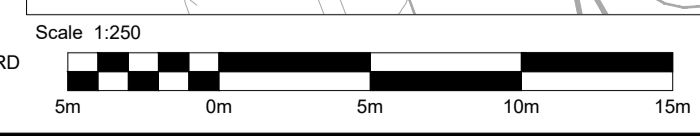

- KEY:**
- FOOTWAY
  - PROPOSED BUS GATE
  - SEGREGATED CYCLE TRACK
  - ADVISORY CYCLE LANE
  - SHARED USE PATH
  - PROPOSED VEHICLE RAMP
  - PROPOSED CYCLOPS
  - PROPOSED KERB
  - PROPOSED FLUSHED KERB
  - PROPOSED NO LOADING "AT ANY TIME"
  - EXISTING NO LOADING "AT ANY TIME" TO REMAIN
  - EXISTING NO LOADING (MON-SAT 8 am - 9.15 am AND 4.30 pm - 6 pm) UPDATED TO NO LOADING "AT ANY TIME"
  - EXISTING NO WAITING "AT ANY TIME" TO REMAIN
  - PROPOSED NO WAITING "AT ANY TIME"
  - EXISTING KERB
  - HIGHWAY SCHEME EXTENT

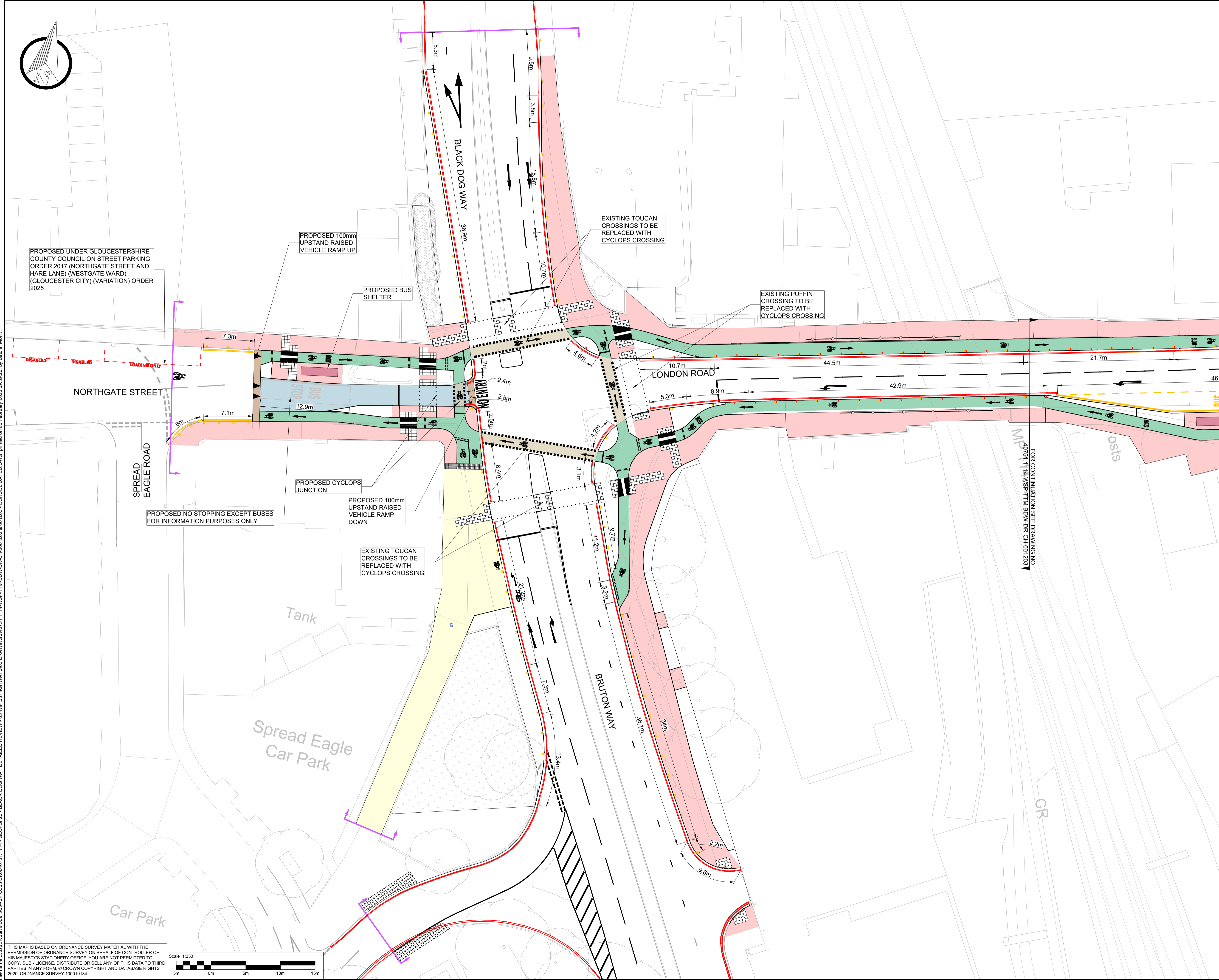

REV	DATE	BY	DESCRIPTION	CHK	APP
P01	05/02/2026	MB	FIRST ISSUE	HL	NP

DRAWING STATUS: **D2 - FOR TENDER**

Shire Hall, Westgate St, Gloucester, GL1 2TG, UK  
T+ 44 (0) 207 314 5000, F+ 44 (0) 207 314 5111  
wsp.com

SITE/PROJECT: **BLACK DOG WAY**

TITLE: **GREAT WESTERN ROAD AND BLACK DOG WAY  
PROPOSED TRAFFIC REGULATION ORDER  
(SHEET 01 OF 02)**

SCALE @ A1:	CHECKED:	APPROVED:	
1:250	HL	ND	
PROJECT NO:	DESIGNED:	DRAWN:	DATE:
40751.1114	MB	MB	FAB 2026
DRAWING NO:	REV:		
40751.1114-WSP-TTM-BDW-DR-CH-001203	P01		

© WSP UK Ltd

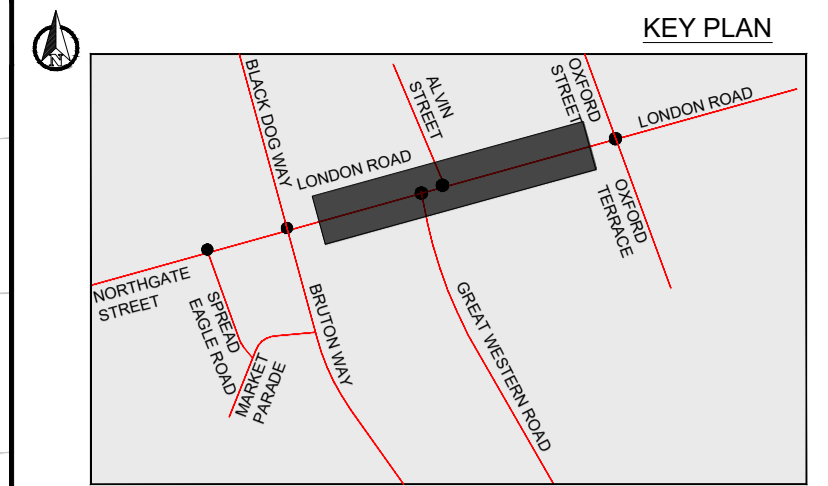
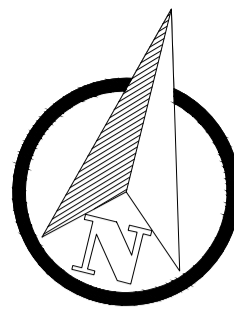

- KEY:**
- FOOTWAY
  - PROPOSED BUS GATE
  - SEGREGATED CYCLE TRACK
  - ADVISORY CYCLE LANE
  - SHARED USE PATH
  - PROPOSED VEHICLE RAMP
  - PROPOSED CYCLOPS
  - PROPOSED KERB
  - PROPOSED FLUSHED KERB
  - PROPOSED NO LOADING "AT ANY TIME"
  - EXISTING NO LOADING "AT ANY TIME" TO REMAIN
  - EXISTING NO LOADING (MON-SAT 8 am - 9.15 am AND 4.30 pm - 6 pm) UPDATED TO NO LOADING "AT ANY TIME"
  - EXISTING NO WAITING "AT ANY TIME" TO REMAIN
  - PROPOSED NO WAITING "AT ANY TIME"
  - EXISTING KERB
  - HIGHWAY SCHEME EXTENT

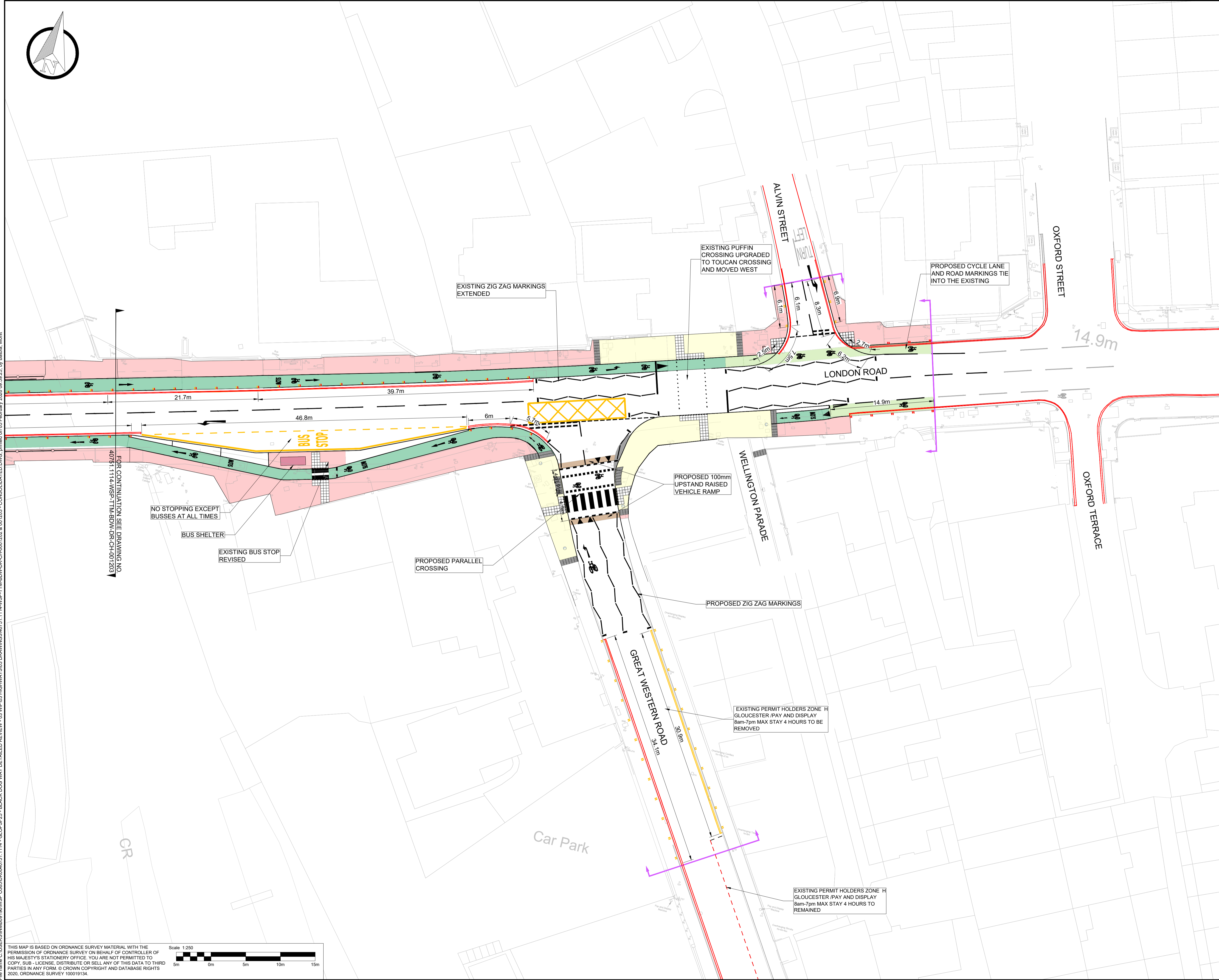

File name: C:\USERS\NMB018\WSP\0365\UK040751.1114 - GLOSP25 - BLACK DOG WAY DETAILED REVIEW - 03 WIP\03 HIGHWAYS\03 DRAWINGS\40751.1114-WSP-TTM-BDW-DR-CH-001203 - CONSOLIDATED.DWG, printed on 05 February 2026 09:59:25, by Babola, Mohit  
 FOR CONTINUATION SEE DRAWING NO 40751.1114-WSP-TTM-BDW-DR-CH-001203

PO1	22/01/2026	MB	FIRST ISSUE	HL	NP
REV	DATE	BY	DESCRIPTION	CHK	APP

DRAWING STATUS: **S3 - FOR REVIEW**



Shire Hall, Westgate St, Gloucester, GL1 2TG, UK  
 T+ 44 (0) 207 314 5000, F+ 44 (0) 207 314 5111  
 wsp.com

CLIENT:



SITE/PROJECT: **BLACK DOG WAY**

TITLE: **GREAT WESTERN ROAD AND BLACK DOG WAY  
 PROPOSED TRAFFIC REGULATION ORDER  
 (SHEET 02 OF 02)**

SCALE @ A1:	1:250	CHECKED:	HL	APPROVED:	ND
PROJECT NO:	40751.1114	DESIGNED:	MB	DATE:	FAB 2026

DRAWING NO:	40751.1114-WSP-TTM-BDW-DR-CH-001203	REV:	P01
-------------	-------------------------------------	------	-----

© WSP UK Ltd

THIS MAP IS BASED ON ORDNANCE SURVEY MATERIAL WITH THE PERMISSION OF ORDNANCE SURVEY ON BEHALF OF CONTROLLER OF HIS MAJESTY'S STATIONERY OFFICE. YOU ARE NOT PERMITTED TO COPY, SUB-LICENSE, DISTRIBUTE OR SELL ANY OF THIS DATA TO THIRD PARTIES IN ANY FORM. © CROWN COPYRIGHT AND DATABASE RIGHTS 2020. ORDNANCE SURVEY 100019134.

Scale 1:250

