

This document is issued for the party which commissioned it and for specific purposes connected with the customer project only. It should not be relied upon by any other party or used for any other purpose. We accept no responsibility for the consequences of this document being relied upon by any other party, or being used for any other purpose, or containing any error or omission which is due to an error or omission in data supplied to us by other parties.

- Notes:**
1. This drawing is copyright protected and may not be reproduced in any form without permission from the Gloucestershire County Council.
  2. All materials in accordance MCHW Volume 1
  3. Prior to removing existing road surface, a detailed record of existing road markings and linings to be recorded to enable new road markings and linings to be placed at correct locations.

- KEY:**
- Proposed Footway construction
  - Existing speed cushion
  - Proposed speed cushion

Rev	Date	Description	Prep	Chk	Apprv
A	23.09.25	New Buildout added	SR	HN	CS

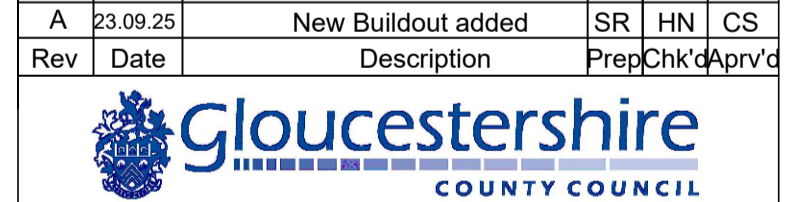

Traffic Engineering,  
Gloucestershire County Council,  
Shire Hall,  
Gloucester,  
GL1 2TG

Drawing Status  
**FOR CONSTRUCTION**

Project  
**ROAD SAFETY HOTSPOT  
HIGH STREET, TREDWORTH  
GLOUCESTER**

Title  
**LOCATION PLAN OF  
PROPOSED BUILDOUTS**

Sheet Size <b>A1</b>	Original scale <b>AS SHOWN</b>	Scheme No. <b>T24003</b>
Drawn/ Prepared by <b>SR</b>	Checked by <b>BT</b>	Approved by <b>HN</b>
Drawn/ Prepared date <b>26.03.2025</b>	Checked date <b>21.05.2025</b>	Approved date <b>20.08.2025</b>
Drawing No. <b>T24003-3454-C-001</b>		Revision <b>A</b>

Layout  
Scale 1:1000

Inset A  
Scale 1:100

This document is issued for the party which commissioned it and for specific purposes connected with the captioned project only. It should not be relied upon by any other party or used for any other purpose. We accept no responsibility for the consequences of this document being relied upon by any other party, or being used for any other purpose, or containing any error or omission which is due to an error or omission in data supplied to us by other parties.

**NOTES:**

1. This drawing is copyright protected and may not be reproduced in any form without permission from the Gloucestershire County Council.
2. All dimensions are in millimetres unless otherwise stated.
3. All materials in accordance MCHW Volume 1
4. Prior to removing existing road surface, a detailed record of existing road markings and linings to be recorded to enable new road markings and linings to be placed at correct locations.
5. When pavement surfaces are being laid, it must be ensured that the pavement material is not forced against the channels.
6. Newly installed bollard to be a minimum of 450mm away from the kerb.
7. Prior to laying the binder course for the buildouts, ensure existing surface is clean and clear of debris, detritus, and standing water. Bond coat to be applied to existing surface and upstands prior to laying binder course.
8. New kerbs to tie into existing levels.

**INSTALLATION NOTES:**

1. For details of installation please see BIRCOprofil installation instructions.
2. Ensure ends of channels are installed leveled with existing carriageway and with a fall of, at least, 1% so water can enter channels and discharge correctly.

B	23.09.25	Additional buildout in Laurels	SR	HN	CS
A	27.08.25	Aco drain extension	MN	BT	HN
Rev.	Date	Description	Prep	Chk'd	Apprv'd



**Gloucestershire**  
COUNTY COUNCIL

Traffic Engineering,  
Gloucestershire County Council,  
Shire Hall,  
Gloucester,  
GL1 2TG

Status: **FOR CONSTRUCTION**

Project:  
**ROAD SAFETY HOTSPOT  
HIGH STREET, TREDWORTH  
GLOUCESTER**

Title:  
**BUILDOUT ON HIGH STREET AT  
JUNCTION WITH THE LAURELS**

Original scale	Scheme No.	
AS SHOWN	T24003	
Drawn/Prepared by	Checked by	Approved by
AJT/SR	BT	HN
Drawn/Prepared date	Checked date	Approved date
15.11.2024	31.07.2025	20.08.2025
Drawing No.	Revision	
T24003-3454-C-002	B	

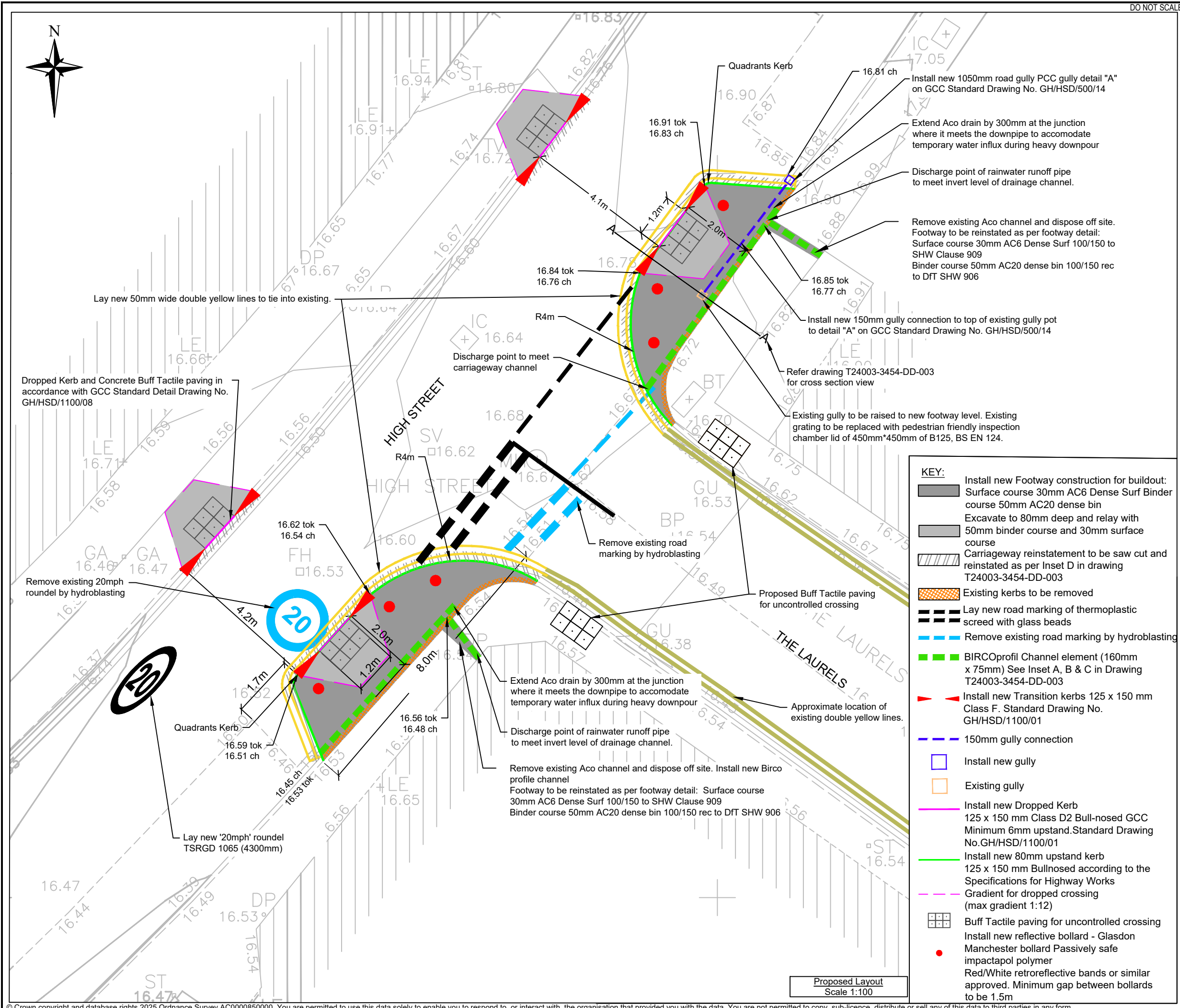

**KEY:**

- Install new Footway construction for buildout: Surface course 30mm AC6 Dense Surf Binder course 50mm AC20 dense bin
- Excavate to 80mm deep and relay with 50mm binder course and 30mm surface course
- Carriageway reinstatement to be saw cut and reinstated as per Inset D in drawing T24003-3454-DD-003
- Existing kerbs to be removed
- Lay new road marking of thermoplastic screed with glass beads
- Remove existing road marking by hydroblasting
- BIRCOprofil Channel element (160mm x 75mm) See Inset A, B & C in Drawing T24003-3454-DD-003
- Install new Transition kerbs 125 x 150 mm Class F. Standard Drawing No. GH/HSD/1100/01
- 150mm gully connection
- Install new gully
- Existing gully
- Install new Dropped Kerb 125 x 150 mm Class D2 Bull-nosed GCC Minimum 6mm upstand. Standard Drawing No. GH/HSD/1100/01
- Install new 80mm upstand kerb 125 x 150 mm Bullnosed according to the Specifications for Highway Works
- Gradient for dropped crossing (max gradient 1:12)
- Buff Tactile paving for uncontrolled crossing
- Install new reflective bollard - Glasdon Manchester bollard Passively safe impactapol polymer Red/White retroreflective bands or similar approved. Minimum gap between bollards to be 1.5m

Proposed Layout  
Scale 1:100



This document is issued for the party which commissioned it and for specific purposes connected with the captioned project only. It should not be relied upon by any other party or used for any other purpose. We accept no responsibility for the consequences of this document being relied upon by any other party, or being used for any other purpose, or containing any error or omission which is due to an error or omission in data supplied to us by other parties.

**NOTES:**

1. This drawing is copyright protected and may not be reproduced in any form without permission from the Gloucestershire County Council.
2. All dimensions are in millimetres unless otherwise stated.
3. Newly installed gullies to be cleaned and drainage to be jetted after carriageway surfacing works.
4. All materials in accordance MCHW Volume 1.
5. Prior to removing existing road surface, a detailed record of existing road markings and linings to be recorded to enable new road markings and linings to be placed at correct locations.
6. Newly installed bollard to be a minimum of 450mm away from edge of kerb.
7. Prior to laying the binder course for the buildouts, ensure existing surface is clean and clear of debris, detritus, and standing water. Bond coat to be applied to existing surface and upstands prior to laying binder course.
8. New kerbs to tie into existing levels

**INSTALLATION NOTES for BIRCOprofil Channel:**

1. For details of installation please see BIRCOprofil reinstatement instructions.
2. Ensure ends of channels are installed leveled with existing carriageway and with a fall of, at least, 1% so water can enter channels and discharge correctly.

Rev.	Date	Description	Prep	Chk'd	Apprv'd
B	11.12.25	Removed existing pole	SR	APC	HN
A	30.09.25	Changed Builtout radius	SR	HN	CS



Traffic Engineering,  
Gloucestershire County Council,  
Shire Hall,  
Gloucester,  
GL1 2TG

Status: **FOR CONSTRUCTION**

Project:  
**ROAD SAFETY HOTSPOT  
HIGH STREET, TREDWORTH  
GLOUCESTER**

Title:  
**NEW BUILDOUT ON HIGH STREET AT  
JUNCTION WITH VICTORY ROAD**

Original scale	Scheme No.	
AS SHOWN	T24003	
Drawn/Prepared by	Checked by	Approved by
AJT/SR	BT	HN
Drawn/Prepared date	Checked date	Approved date
15.11.2024	31.07.2025	20.08.2025

Drawing No. **T24003-3454-C-003** Revision **B**

- KEY:**
- Install new Footway construction for buildout:
    - Surface course 30mm AC6 Dense Surf
    - Binder course 50mm AC20 dense bin
  - Excavate to 80mm deep and relay with 50mm binder course and 30mm surface course
  - Carriageway reinstatement to be saw cut and reinstated as per Inset D in drawing T24003-3454-DD-003
  - Lay new road marking of thermoplastic screed with glass beads
  - Remove existing road markings by hydroblasting
  - Existing kerbs to be removed
  - BIRCOprofil Channel element (160mm x 75mm) See Inset A, B & C in drawing T24003-3454-DD-003
  - 150mm gully connection
  - Install new gully
  - Existing gully
  - Install new Transition kerbs 125 x 150 mm Class F Standard Drawing No. GH/HSD/1100/01
  - Install new Dropped Kerb 125 x 150 mm Class D2 Bull-nosed GCC Minimum 6mm upstand. Standard Drawing No. GH/HSD/1100/01
  - Install new 80mm upstand kerb 125 x 150 mm Bullnosed according to the Specification for Highway Works
  - Gradient for dropped crossing (max gradient 1:12)
  - Proposed Buff Tactile paving for uncontrolled crossing
  - Existing Buff Tactile paving for uncontrolled crossing
  - Install new reflective bollard - Glasdon Manchester bollard Passively safe impactapol polymer Red/White retroreflective bands or similar approved. Minimum gap between bollards to be 1.5m
  - Existing street furniture to be removed

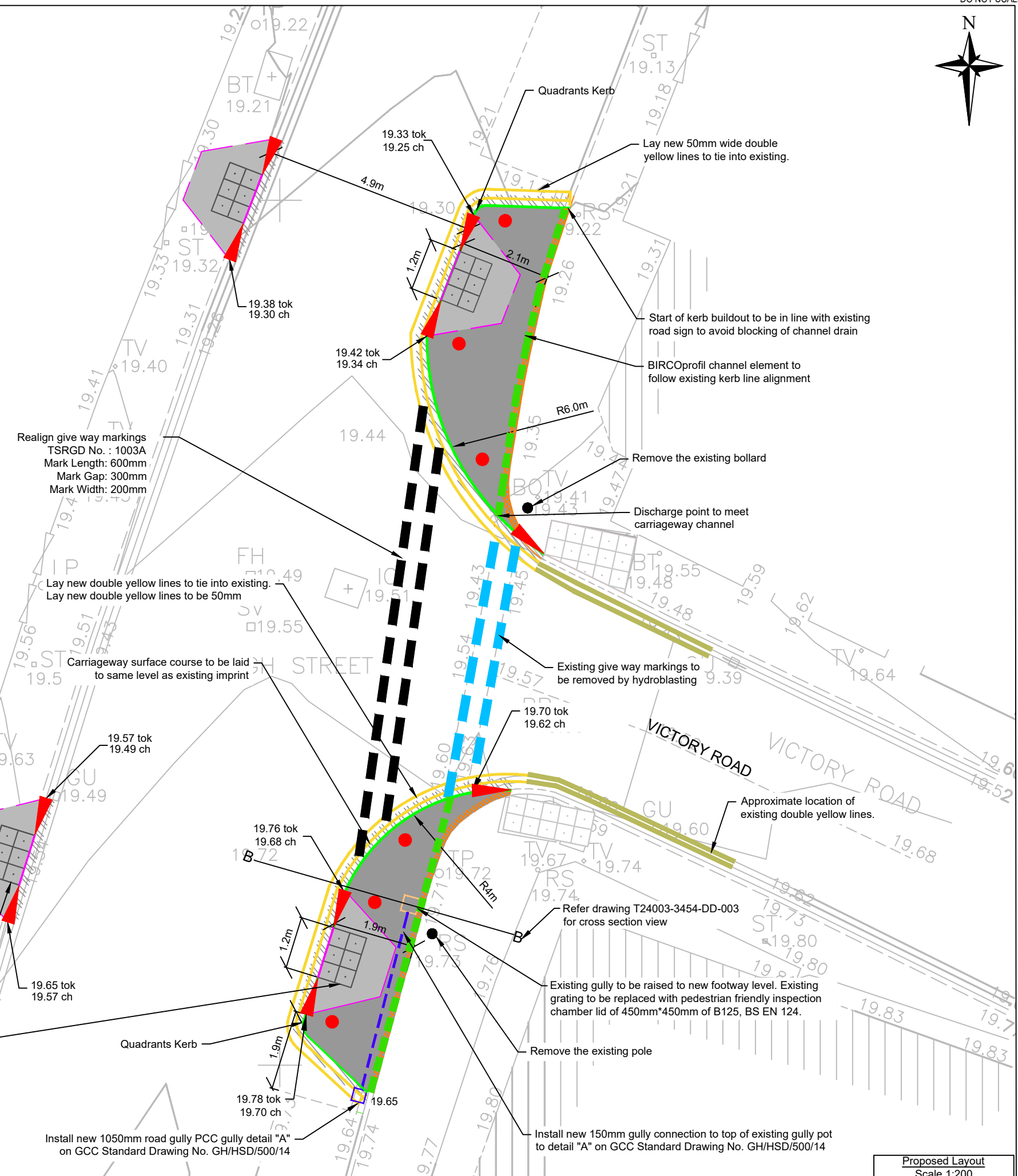

Proposed Layout  
Scale 1:200