

DOCUMENT 9

GENERAL ARRANGEMENT PLAN

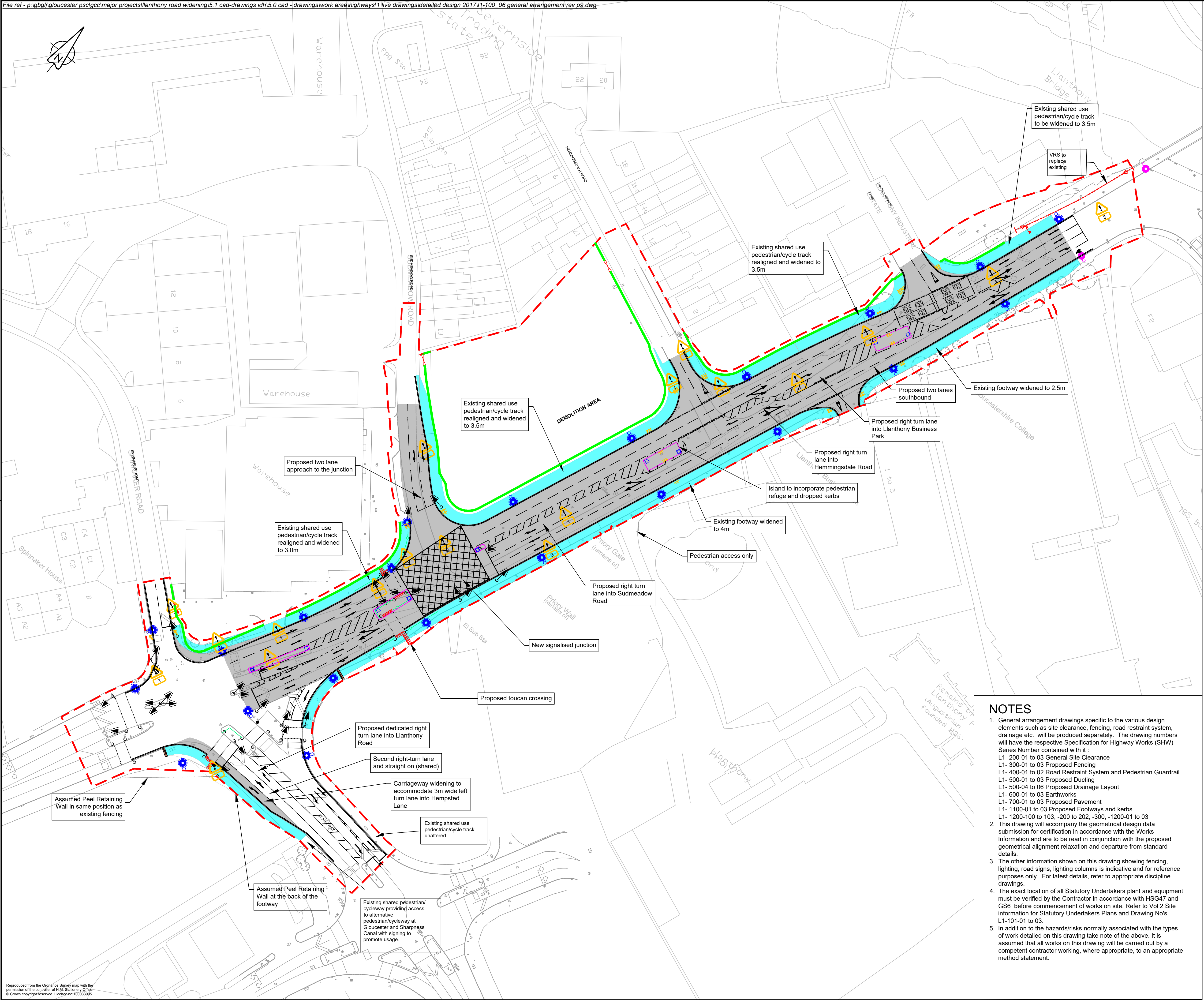

RESIDUAL DESIGN HAZARDS

(The following information has been collected from Preconstruction Information and Amey Process PLC-H&S-201 – Hazard Management for Designers.)

- Underground services (Gas, Electricity, Water, BT).
- Overhead services (BT).
- Working adjacent to Priory Wall.

KEY

- Proposed Footway Improvement
- Proposed Highway Improvement
- Scheme Extents
- Proposed Pedestrian Guardrail to be installed
- Proposed fencing to be installed
- New VRS to be installed
- Traffic Signal
- Proposed Lighting Column
- Existing Lighting Column to remain
- Proposed Keep Left Bollard
- Dropped kerbs and buff coloured tactile paving
- Dropped kerbs and red coloured tactile paving
- Proposed Corduroy tactile paving
- Proposed location of substantial sign
- Proposed Gates

P9	Annotation revised	LJ	RS	RS	01/10/19
P8	Amended as per GE fencing changes	SR	MLC	SC	04/03/19
P7	Amended as per BT STATS diversions 09/01/19	SR	MLC	SC	11/01/19
P6	Amended as per Collision Assessment Report	SR	MLC	AP	14/12/18
P5	To show updates since planning application submitted	SR	MLC	AP	27/11/18
P4	Amended as per AB comments	SR	MLC	AP	16/11/18
P3	Amended to incorporate cycleway/footway changes	SR	AP	AP	12/11/18
P2	Amends as per RS comments 24/07/18	SR	MLC	AP	24/07/18
P1	Amends as per RS comments 03/07/18	SR	.	.	03/07/18
Rev	Revision details	Drwn	Chkd	Appd	Date
Designed:	RM				Date: 11-05-18
Drawn:	RM				Date: 11-05-18
Checked:	LM				Date: 11-05-18
Approved:	RS				Date: 11-05-18

Copyright © Amey

ameyconsulting

www.amey.co.uk

Client

Gloucestershire

COUNTY COUNCIL

Project Name

GSWB (Llanthony Road) Widening

Drawing Title

General Arrangement

Original Drawing Size : A1	Scale : 1:600
Dimensions : m	

Drawing Status	Suitability
FOR TENDER	D2

Drawing No	Rev
L1-100-06	P9

NOTES

- General arrangement drawings specific to the various design elements such as site clearance, fencing, road restraint system, drainage etc. will be produced separately. The drawing numbers will have the respective Specification for Highway Works (SHW) Series Number contained with it :
 - L1- 200-01 to 03 General Site Clearance
 - L1- 300-01 to 03 Proposed Fencing
 - L1- 400-01 to 02 Road Restraint System and Pedestrian Guardrail
 - L1- 500-01 to 03 Proposed Ducting
 - L1- 500-04 to 06 Proposed Drainage Layout
 - L1- 600-01 to 03 Earthworks
 - L1- 700-01 to 03 Proposed Pavement
 - L1- 1100-01 to 03 Proposed Footways and kerbs
 - L1- 1200-100 to 103, -200 to 202, -300, -1200-01 to 03
- This drawing will accompany the geometrical design data submission for certification in accordance with the Works Information and are to be read in conjunction with the proposed geometrical alignment relaxation and departure from standard details.
- The other information shown on this drawing showing fencing, lighting, road signs, lighting columns is indicative and for reference purposes only. For latest details, refer to appropriate discipline drawings.
- The exact location of all Statutory Undertakers plant and equipment must be verified by the Contractor in accordance with HSG47 and GS6 before commencement of works on site. Refer to Vol 2 Site information for Statutory Undertakers Plans and Drawing No's L1-101-01 to 03.
- In addition to the hazards/risks normally associated with the types of work detailed on this drawing take note of the above. It is assumed that all works on this drawing will be carried out by a competent contractor working, where appropriate, to an appropriate method statement.