



Deep Street , Prestbury , Cheltenham

£349,950



 3  0  2

Freehold | EPC rating: D

- Offers considered
- Desirable Prestbury location
- Two allocated parking spaces

- Chain free
- Walking distance to High Street
- Long enclosed rear garden

BELVOIR!

Property is personal

Email
Leah.banks@belvoir.co.uk

Phone
01242 221188

Description

For sale on behalf of Gloucestershire County Council & offers to be considered by 7th April 2026.

Presenting a distinguished Victorian semi-detached house situated in the sought-after Prestbury area of Cheltenham, Gloucestershire. This residence, set on an attractive size plot, represents a compelling opportunity for those seeking a property to personalise, as modernisation is required throughout.

The accommodation comprises three bedrooms, offering versatile living space suitable for a variety of lifestyle requirements. The property features two well-proportioned reception rooms, facilitating comfortable family life or entertaining guests. Gas central heating ensures efficient and reliable warmth throughout the home.

One of the notable features of the property is the large enclosed rear garden, providing a private and expansive outdoor area ideal for recreation, relaxation, or gardening pursuits. The private nature of the garden offers a sense of seclusion and tranquillity. For those with vehicles, the property benefits from private parking, with two allocated spaces providing convenience and peace of mind.

Photographs



Disclaimer:

Please note this is not specific to this property but may still apply. Appliances such as radiators, heaters, boilers, fixtures or utilities which may have been mentioned in these details have not been tested and no guarantee can be given that they are suitable or in working order. We cannot guarantee that building regulations or planning permission has been approved and would recommend that prospective purchasers should make their own independent inquiries on these matters. All measurements are approximate.

Floorplan

Approx Gross Internal Area
92 sq m / 993 sq ft

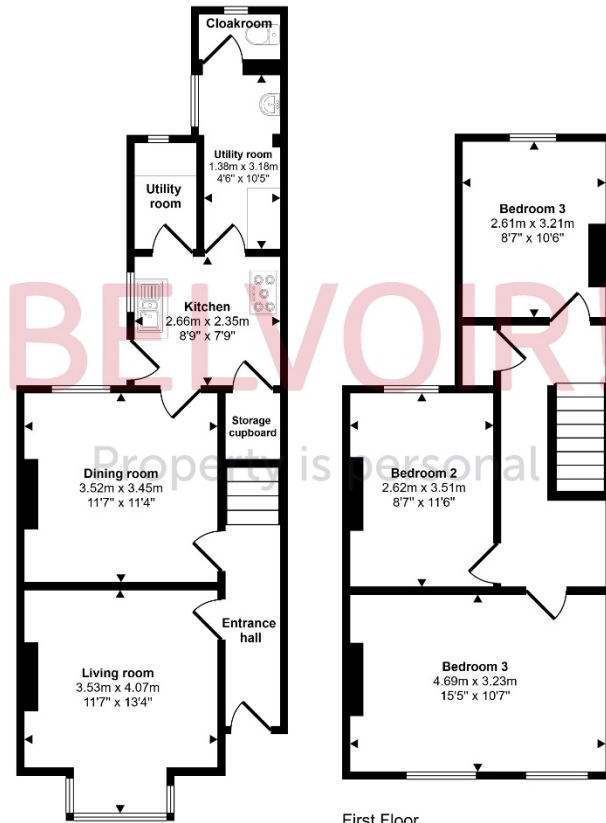

Ground Floor
Approx 48 sq m / 519 sq ft

First Floor
Approx 44 sq m / 474 sq ft

Map

