



## London Road and Black Dog Way

**Montel Civil Engineering** has been appointed by **Gloucestershire County Council** as the main contractor to deliver highways improvements and cycleways along London Road and Black Dog Way.

Works on Phase 2 outside St Peter's Church are well underway and are due to be completed by 9<sup>th</sup> June. Phases 3B1 & 3B2 will commence after completion of Phase 2 works.

Phase 3A1 began on the 20<sup>th</sup> April and is due for completion by the 5<sup>th</sup> June. Phase 3A2 & Phase 3C1 will commence after completion of Phase 3A1 (Please see the work phase plan below).

The new footpath and cycleway on London Road alongside St Peter's Church will be open by 9<sup>th</sup> June. The footpath in front of Roberts Limbrick will be closed during Phase 3B1.

As we move into the new phases, we will retain the temporary mini roundabout and introduce a one-way system for traffic entering London Road from Bruton Way and Black Dog Way. Traffic will be unable to enter London Road after Alvin Street but will instead be re-directed via a signposted diversion. The bus stop outside Badham's Pharmacy will be suspended until early October. Driving from Bruton Way and Black Dog Way onto London Road will remain possible.

Additional pedestrian crossing facilities will be installed on London Road and Black Dog Way to maintain safe pedestrian routes into the city. Additional signs will be installed to aid with signposting pedestrians and cyclists.

If you have any specific queries, concerns or would like to be added to the mailing list:  
**Please contact: [blackdogway@montel-group.com](mailto:blackdogway@montel-group.com)**





We work closely with key local stakeholders and businesses to ensure that they are consulted and kept informed about the changes to the footpaths and highways. We would also like to thank St Peter's Church, the Esso Garage and Roberts Limbrick for working with us during the ongoing works.

If you have any specific queries, concerns or would like to be added to the mailing list:  
Please contact: [blackdogway@montel-group.com](mailto:blackdogway@montel-group.com)



Phase 2 - Aerial view of London Road approaching Black Dog Way

If you have any specific queries, concerns or would like to be added to the mailing list:  
**Please contact: [blackdogway@montel-group.com](mailto:blackdogway@montel-group.com)**





Phase 3A1 - Aerial view of London Road and Great Western Road

If you have any specific queries, concerns or would like to be added to the mailing list:  
**Please contact: [blackdogway@montel-group.com](mailto:blackdogway@montel-group.com)**



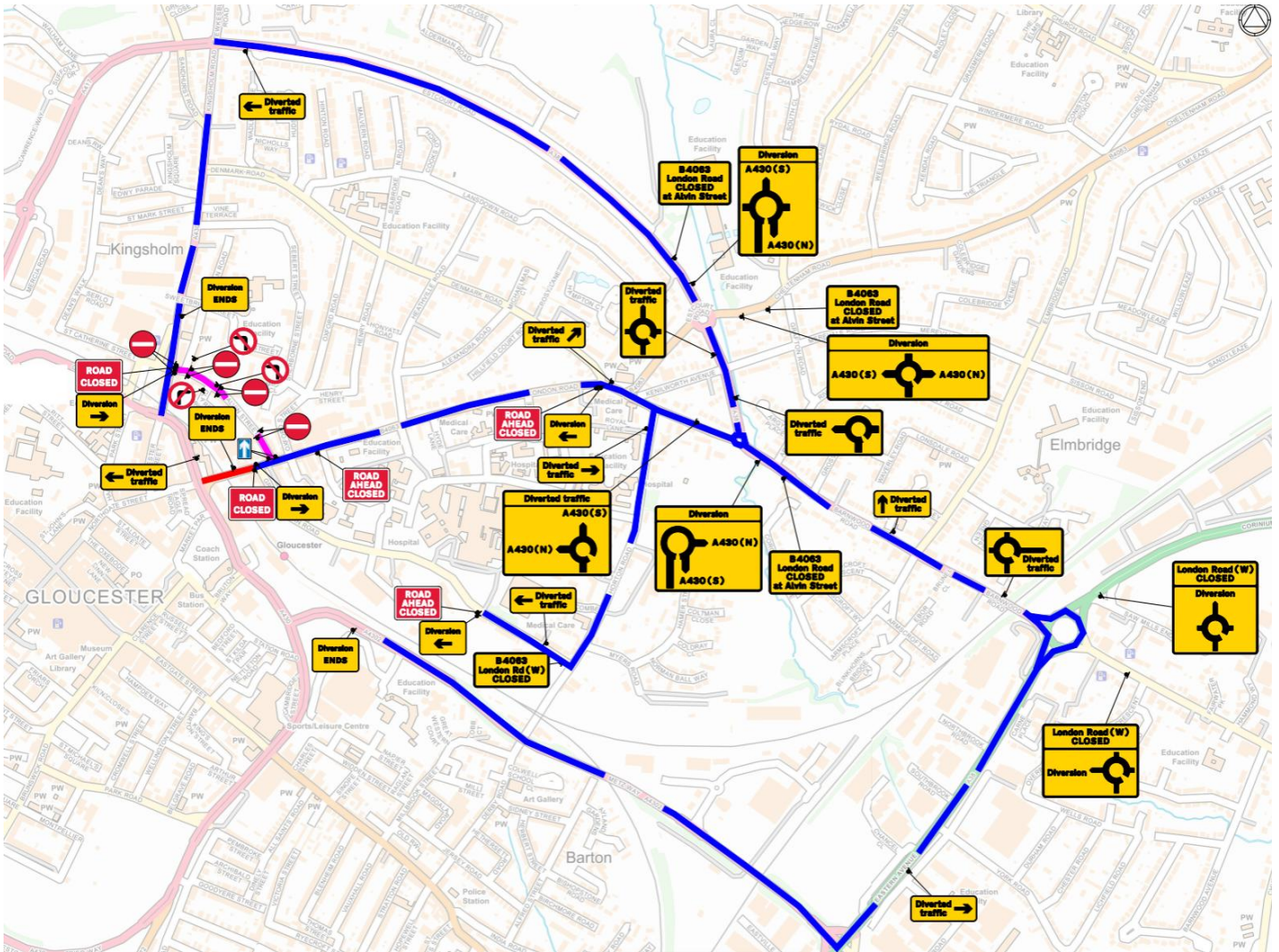

New Diversion Map

If you have any specific queries, concerns or would like to be added to the mailing list:  
Please contact: [blackdogway@montel-group.com](mailto:blackdogway@montel-group.com)