

COVERING LIST OF REPRESENTATIONS AND OBJECTIONS TO THE ORDER

Objector - 1

Linda Maiik (owner of land coloured green on plan overleaf)

Email -:

Objector – 2

Kay Nagai (son of Ms Maiik)

Email –

Objector – 3

Mr C Townley

The Open Spaces Society

Email -

Objector – 4

Mr G Tennant

Email -

Objector – 5

Mr N Fawkes

Email -

Representations

National Plant Enquiries

Email - osm.enquiries@atkinsglobal.com

Openreach (Steve Phillips)

Email -

The Stroud Rambling Club (Penny Fernando)

Email -

Ms S Roff (Taylor Wimpey TW Bristol) (owner of land coloured yellow on plan overleaf)

Email -

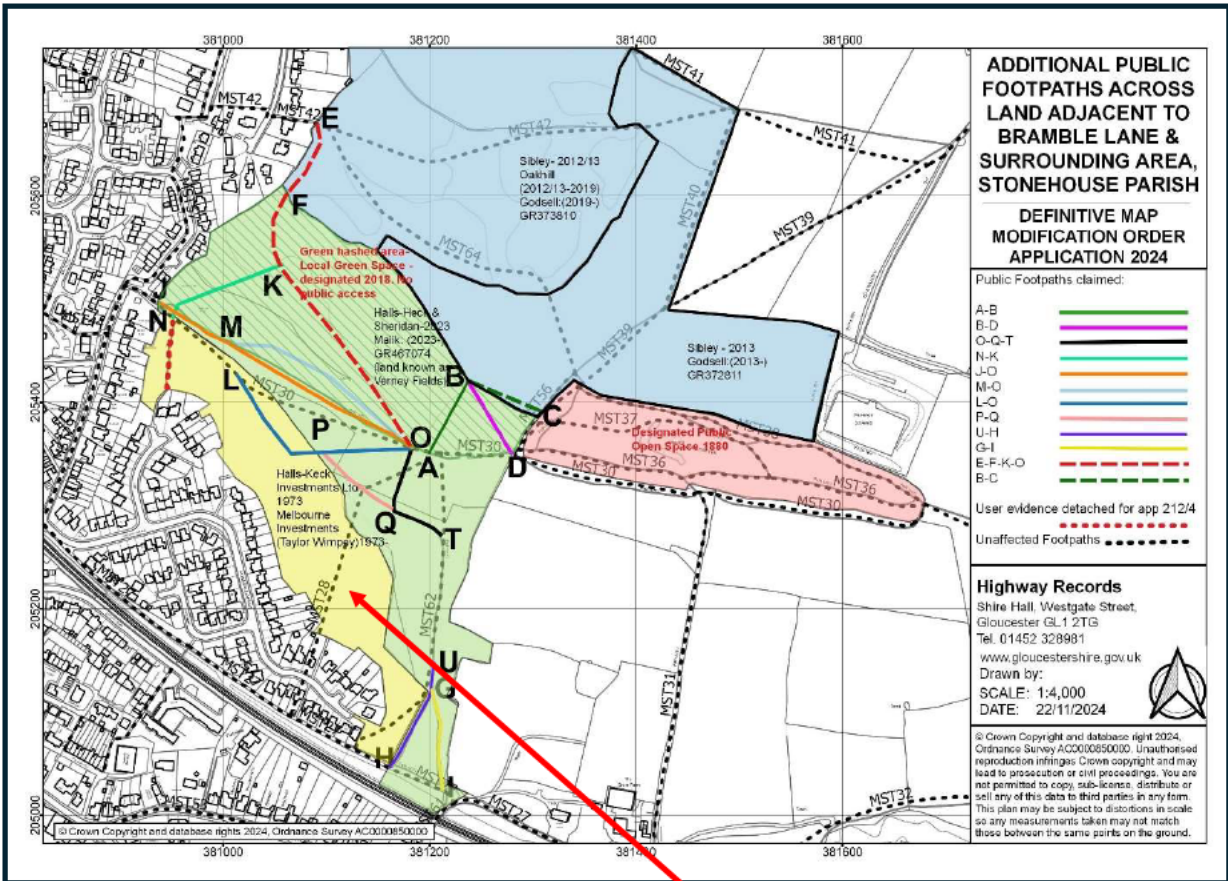

ADDITIONAL PUBLIC FOOTPATHS ACROSS LAND ADJACENT TO BRAMBLE LANE & SURROUNDING AREA, STONEHOUSE PARISH

DEFINITIVE MAP MODIFICATION ORDER APPLICATION 2024

- Public Footpaths claimed:
- A-B
 - B-D
 - O-Q-T
 - N-K
 - J-O
 - M-O
 - L-O
 - P-Q
 - U-H
 - G-I
 - E-F-K-O
 - B-C
- User evidence detached for app 212/4
- Unaffected Footpaths

Highway Records
 Shire Hall, Westgate Street,
 Gloucester GL1 2TG
 Tel. 01452 328981
 www.gloucestershire.gov.uk
 Drawn by:
 SCALE: 1:4,000
 DATE: 22/11/2024

© Crown Copyright and database right 2024. Ordnance Survey AC0000650000. Unauthorised reproduction infringes Crown copyright and may lead to prosecution or civil proceedings. You are not permitted to copy, sub-license, distribute or sell any of this data to third parties in any form. This plan may be subject to distortions in scale so any measurements taken may not match those between the same points on the ground.